



169QBX

New



176BHX

New

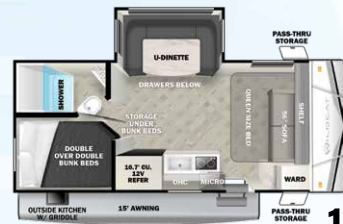

182DBX

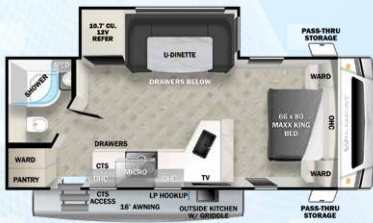

233RBX



243DBX



T247RKX

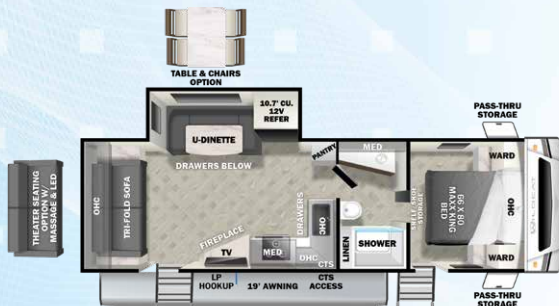

T262RSX

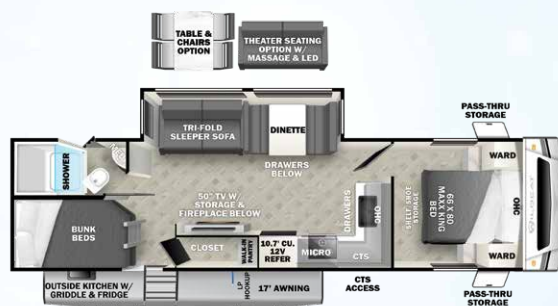

T269DBX



T266MEX



T276FKX



T282RKX



T303MBX

WILDCAT TRAVEL TRAILER SPECIFICATIONS

	169QBX	176BHX	182DBX	233RBX	243DBX	T247RKK	T262RSX	T266MEX	T269DBX	T276FKX	T282RKK	T303MBX
LENGTH	23' 1"	23' 1"	22' 11"	26' 11"	29' 5"	30' 11"	31' 8"	32' 7"	34' 6"	33' 11"	34' 8"	35' 6"
HEIGHT	10' 8"	10' 8"	10' 8"	11' 5"	11' 5"	11' 5"	11' 5"	11' 5"	11' 5"	11' 5"	11' 5"	11' 5"
HITCH WEIGHT	575 LB.	530 LB.	550 LB.	665 LB.	710 LB.	680 LB.	714 LB.	912 LB.	984 LB.	1,045 LB.	940 LB.	786 LB.
UVW	4,036 LB.	4,066 LB.	4,079 LB.	6,056 LB.	6,329 LB.	6,747 LB.	6,879 LB.	7,097 LB.	7,339 lb.	7,992 LB.	7,323 LB.	7,911 LB.
CCC	939 LB.	864 LB.	871 LB.	3,409 LB.	3,181 LB.	2,733 LB.	2,635LB.	2,615 LB.	2,445 lb.	1,853 LB.	2,417 LB.	1,675 LB.
FRESH WATER	39 GAL.	39 GAL.	38 GAL.	61 GAL.	61 GAL.	61 GAL.	61 GAL.	61 GAL.	61 GAL.	61 GAL.	61 GAL.	61 GAL.
GREY WATER	27 GAL.	27 GAL.	32 GAL.	64 GAL.	64 GAL.	64 GAL.	64 GAL.	74 GAL.	75 GAL.	64 GAL.	64 GAL.	64 GAL.
BLACK WATER	27 GAL.	27 GAL.	27 GAL.	27 GAL.	32 GAL.	32 GAL.	32 GAL.	32 GAL.	33 GAL.	32 GAL.	32 GAL.	32 GAL.
AWNING	15'	15'	15'	16'	17'	19'	19'	20'	17'	18'	20'	20'

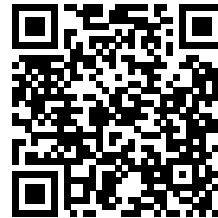

Keep Exploring

Scan for additional specs, photos, videos, and more!



PRE-DELIVERY INSPECTION FACILITY

20,000 square feet of quality assurance. The bare essentials for a premium product. This state-of-the-art facility gives immediate daily feedback to production for quality assurance in every unit built.

CUSTOMER SATISFACTION



www.ForestRiverBuyLocal.com

Download our Forest River mobile app or visit our dynamic online manual to enhance your ownership experience. These interactive options provide incredible ease and insight into use, maintenance and enjoyment of your Forest River product.

Ranging from "How-To" videos, pictures and illustrations of various components, systems and features, to fully searchable content and downloadable PDFs for individual component owner's manuals, answers are always just a click away. View the online manual at www.forestriverinc.com/OnlineManual or download our FREE app from the App Store or Google Play!



GVWR (Gross Vehicle Weight Rating) - is the maximum permissible weight of the unit when fully loaded. It includes all weights, inclusive of all fluids, cargo, optional equipment and accessories. For safety and product performance do NOT exceed the GVWR.

GAWR (Gross Axle Weight Rating) - is the maximum permissible weight, including cargo, fluids, optional equipment and accessories that can be safely supported by a combination of all axles.

UVW (Unloaded Vehicle Weight)* - is the typical weight of the unit as manufactured at the factory. It includes all weight at the unit's axle(s) and tongue or pin and LP Gas. The UVW does not include cargo, fresh potable water, additional optional equipment or dealer installed accessories.

CCC (Cargo Carrying Capacity)** - is the amount of weight available for fresh potable water, cargo, additional optional equipment and accessories. CCC is equal to GVWR minus UVW. Available CCC should accommodate fresh potable water (8.3 lbs per gallon). Before filling the fresh water tank, empty black and gray tanks for more cargo capacity.

*Estimated Average based on standard build optional equipment. ** Estimated average based on standard build optional equipment. Values estimated at time of printing.

Each Forest River RV is weighed at the manufacturing facility prior to shipping. A label identifying the unloaded vehicle weight of the actual unit and the cargo carrying capacity is applied to every Forest River RV prior to leaving our facilities. The load capacity of your unit is designated by weight, not by volume, so you cannot necessarily use all available space when loading your unit.

All information contained in this brochure is believed to be accurate at the time of publication. However, during the model year, it may be necessary to make revisions and Forest River, Inc., reserves the right to make all such changes without notice, including prices, colors, materials, equipment and specifications as well as the addition of new models and the discontinuance of models shown in this brochure. Therefore, please consult with your Forest River, Inc., dealer and confirm the existence of any materials, design or specifications that are material to your purchase decision. ©2023 Wildcat, a division of Forest River Inc., a Berkshire Hathaway company.

FREE MEMBERSHIP
to Forest River Owners' Group

www.forestriverfrog.com



**24/7 EMERGENCY
ROADSIDE ASSISTANCE
WITH VEHICLE PURCHASE***

TOWING
JUMP-STARTS
TIRE CHANGES
FLUID DELIVERY
LOCKOUT
SERVICE

WINCH-OUT
MOBILE MECHANIC
TECHNICAL
SUPPORT
DEALER LOCATOR
SERVICES



*VALID FOR 1 YEAR FROM DATE OF PURCHASE



Learn More

Scan this barcode using a QR Reader on your smart phone to learn more about Forest River.



A Berkshire Hathaway company.